

# REI

**6.88" 2 DIN Capacitive Touch Screen AM/FM Multimedia Receiver  
with CD/DVD, USB/uSD, Auxiliary A/V Inputs, Bluetooth®, PA**



Installation/ Operation Manual

50W x 4

**VR-6200D**

Thank you for purchasing the 6.88" Touch Screen AM/FM Multimedia Receiver from REI. This product is designed and tested to withstand temperature and vibration extremes. Please read the owner's manual carefully before attempting to install this unit.

If you have an installation question or need installation assistance, please call the:

**SERVICE HOT LINE**  
**1-877-726-4617 Toll Free USA & CANADA**

**IF ADDITIONAL INSTALLATION COMPONENTS ARE NECESSARY, CONTACT YOUR REI SALES REP FOR:**

- \*\* OEM /FACTORY WIRING HARNESS ADAPTERS**
- \*\* ANTENNAS & ANTENNA ADAPTERS**
- \*\* SPEAKERS & GRILLS**

**Radio Engineering Industries, Inc.**

6534 "L" Street  
Omaha, Nebraska 68117  
(800)228-9275

[www.radioeng.com](http://www.radioeng.com)

Your player will play commercial DVDs with region code  labels on them.

**FEATURES:**

- 6.88 2 DIN 1024x600 LCD Capacitive Touch Screen
- 50W x 4 audio amp
- AM/FM w/ RDS
- 30 Radio Stations (18 FM, 12 AM)
- CD/DVD Playback
- Front 3.5mm Aux Input
- Rear RCA Auxiliary A/V Inputs
- Front Panel Type A USB 5V/1.0A
- MP3/WMA /MPEG-1/MPEG-2/MPEG-4 & WMV playback
- Android device control via USB Autolink Multimedia APP
- Dual Camera Inputs
- Front/Rear/Subwoofer Line level audio pre-outs
- Bluetooth® v4.0 Hands Free Calling and A2DP audio streaming
- PA Microphone input
- Wireless remote control



**Radio Engineering Industries, Inc.**

[radioeng.com](http://radioeng.com)

Rev A.3 Date: 8-17-21

## CONTENTS

Front controls and Indicators.....	4
Home Screen.....	5
Setup.....	5
Audio Controls.....	7
Media .....	9
Bluetooth Setup.....	10
Setting the Time.....	13
Radio Operation.....	16
Disc Operation.....	17
Phone Link.....	20
USB/uSD media.....	21
Connecting a Bluetooth® Device.....	23
Bluetooth® Phone Operation.....	24
Recent Calls.....	24
Phone Contacts.....	25
Bluetooth® Audio Streaming.....	25
Aux A/V Operation.....	26
Camera 2 Operation.....	26
Changing the Wallpaper .....	27
Back-up Camera Operation.....	27
Supported File Types.....	27
Remote Control.....	28
Troubleshooting.....	29
Radio Dimensions.....	30
Radio Installation.....	30
Radio Removal.....	32
PA Operation .....	32
Electrical Connections.....	33
Specifications.....	34

## FRONT CONTROLS AND INDICATORS



- 1. Disc Slot:**  
Accepts DVD/CD discs.
- 2. LCD Screen and Touch Screen:**  
Touch icons on this screen to access menus or control functions.
- 3. Front Bluetooth Mic:**  
Front Microphone for Hands Free Calling. (An optional external MIC input can be found on the rear)
- 4. 3.5mm AUX IN Jack:**  
This connector accepts analog audio from portable devices.
- 5. USB Slot:**  
Supports playback of supported files via USB flash memory. Screen mirroring/charging with Autolink App.
- 6. Remote Sensor:**  
Used to receive command signals from the remote control.
- 7. Interface Cover:**  
Covers the USB slot and RESET switch.
- 8. Power On/Off, Volume Control Knob:**  
Press to turn the unit ON. Press and hold to turn the unit OFF. Rotate the knob to adjust the volume.
- 9. HOME Button:**  
Press this button to access the Main Source Menu.
- 10. FF/REW Button:**  
Press this button to change tracks/stations.
- 11. Eject Button:**  
Press this button to eject a DVD/CD disc.
- 12. Reset switch:**  
Under the interface cover, Resets the unit back to factory default.
- 13. uSD Slot:**  
Supports playback of supported files via uSD flash memory.

## REI LIMITED WARRANTY

### What Does This Warranty Cover?

This warranty only covers failures due to defects in materials or workmanship which occur during normal use.

### What Does This Warranty Not Cover?

This warranty does not cover damage which occurs in shipment or failures which are caused by products not supplied by REI or failures which result from accident, misuse, abuse, neglect, mishandling, misapplication, faulty installation, set-up adjustment, improper maintenance, alteration, improper antenna, inadequate signal pick-up, maladjustment of consumer controls, modification, line power surge, or damage that is attributable to acts of God, or service by anyone other than a REI Factory Service Center. This warranty does not include service or labor charges connected with the determination or replacement of defective parts or the operation of this equipment. REI is not responsible for any labor charges incurred by any person or company other than REI authorized repair centers.

### LIMITS AND EXCLUSIONS

There are no express warranties except as listed above.

REI SHALL NOT BE LIABLE FOR INCIDENTAL OR CONSEQUENTIAL DAMAGES RESULTING FROM THE USE OF THIS PRODUCT, OR ARISING OUT OF ANY BREACH OF THIS WARRANTY, INCLUDING WITHOUT LIMITATION, DAMAGES TO TAPES OR DISCS. ALL EXPRESS AND IMPLIED WARRANTIES, INCLUDING THE WARRANTIES OF MERCHANTABILITY, ARE LIMITED TO THE APPLICABLE WARRANTY PERIOD SET FORTH BELOW. Some states do not allow the exclusion or limitation of incidental or consequential damages, or limitations on how long an implied warranty lasts, so the above exclusions or limitations may not apply to you.

This warranty gives you specific legal rights and you may also have other rights which vary from state to state.

### What is the Period of Coverage?

REI will repair this product, free of charge, from the date of original purchase in the event of a defect in materials or workmanship as follows:

**For ninety (90) days** - microphones, speakers, antennas, housings, rechargeable batteries, remanufactured product and all non-warranty repairs (replaced parts and labor only).

**For one (1) year** - all other manufactured products.

**For three (3) years** - select manufactured motorcoach products.

**For three (3) years** - select surveillance equipment.

REI may have contractual agreements which provide REI motorcoach and surveillance products with additional coverage.

Call 877-726-4617 for details.

Any product supplied by REI, but not manufactured by REI, will include the original manufacturers warranty only.

### What Will REI Do to Correct Problems?

Once the product is deemed by REI to be a warrantable defect, REI will, at its own discretion, repair or replace the product with new or reconditioned product. All warranty repairs and/or product replacements will include the remaining warranty from the original purchase date.

### How Do You Get Service?

For assistance in obtaining service for REI products call toll free 877-726-4617 (Continental United States and Canada only) or 402-339-2200 (outside Continental United States and Canada) between the hours of 7:00A.M. - 5:00P.M. CST Monday thru Friday (excluding Holidays).

Prior to calling REI, customers must have the part number, serial number, VIN number (if it's a motorcoach product) and detailed description of the problem ready to provide to the REI service representative. After providing the proper information to REI, customers will be issued a return authorization number. When the REI service representative provides the return authorization number, they will also give instructions for returning the item. Any discrepancies in following this procedure may cause shipments to be refused or warranty claims to be rejected.

**IMPORTANT!** REI does not accept product returns for repair or replacement without first issuing a return authorization number. All returns must be sent freight prepaid and insured by the customer. REI will not accept COD shipments.

**IMPORTANT!** REI does not accept responsibility for lost shipments. It is the customer's responsibility to provide REI with the part number, serial number, return authorization number and shipper tracking number in the event REI does not have record of receiving product for repair or replacement.

Once warranty service has been performed on your product, REI will ship the item freight prepaid to any business address in the Continental United States or Canada. Customers located outside the Continental United States and Canada are responsible for all freight charges. Any duties or fees, if any, are the customer's responsibility.

Any repair deemed non-warranty by REI will be subject to all freight charges, and in some cases inspection fees, to be paid by the customer. These fees may exist regardless of whether the product is repaired. If a customer requires help in trouble shooting a problem, contact REI and request technical assistance before requesting a return authorization number.

### What Must You Do To Keep This Warranty in Effect?

KEEP YOUR ORIGINAL PROOF OF PURCHASE AS IT MAY BE REQUIRED IN ORDER TO RECEIVE WARRANTY SERVICE.

Make sure the serial number is not removed, altered or defaced.

Do not attempt to have your product repaired by anyone other than a REI Factory Service Center.

Also, see "What Does This Warranty Not Cover".

### REI AUTHORIZED REPAIR FACILITIES:

REI	REI
6534 L Street	1376 Bennett Drive, Unit 126
Omaha, Nebraska 68117	Longwood, Florida 32750
Phone: 877-726-4617	

### What if your Product is a Non-Warranty Repair?

All Products sent to REI for repair which are determined, at REI's discretion, to be non-warrantable repair may incur inspection fees regardless of actual repair being performed or will incur repair fees if the product is repaired. All non-warranty repairs include a 90 day warranty for any components that are replaced, if any, and labor performed. Inspection fees apply regardless of whether a product is determined to be non-warrantable prior to shipping to REI. All freight charges, duties or fees associated with non-warranty repair are the customer's responsibility.

FORM 640020 REV 0.1

## **BLUETOOTH®**

Version	Bluetooth® 4.0 Certified
Frequency Range	2.402 – 2.480 GHz
Output power	+4dBm Max
Profiles supported	HFP 1.5, A2DP 1.2, AVRCP 1.0, & PBAP

## **USB/SD INTERFACE**

USB Standard	USB1.1/2.0 (Full Speed)
Maximum Supply Current	1.0A
File System	Fat16/32

## **AUXILIARY INPUT SPECIFICATIONS**

Frequency Response (+/- 1db)	20HZ – 20Khz (+/-3dB)
Input Voltage Maximum Voltage	1.2V
Input impedance	10KΩ

## **VIDEO PLAYBACK**

Format	NTSC
Video Input/Output level	1.0V p-p/75Ω (+/-0.2V)

## **MONITOR**

Screen Size	6.88” Measured Diagonally (16:9 Widescreen)
Screen Type	TFT LCD, LED Backlighting
Resolution	(1024x600)

*\* Design and specifications are subject to change without notice.*

## **HOME SCREEN**

From the HOME screen you can use the touch screen to change the source. Touch either the Radio, Disc, Phone Link, USB, SD, Bluetooth, Aux Video in, Camera 2, Wallpaper, or Setup.

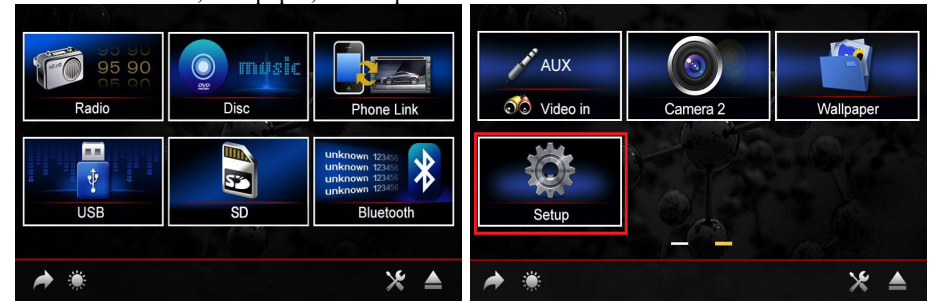

## **SETUP**

Touch the SETUP icon on the HOME page to access the Setup pages. Use the Up/Down arrows to access page 2. Use the RETURN arrow to go back. Use the HOME button to return to the HOME screen.

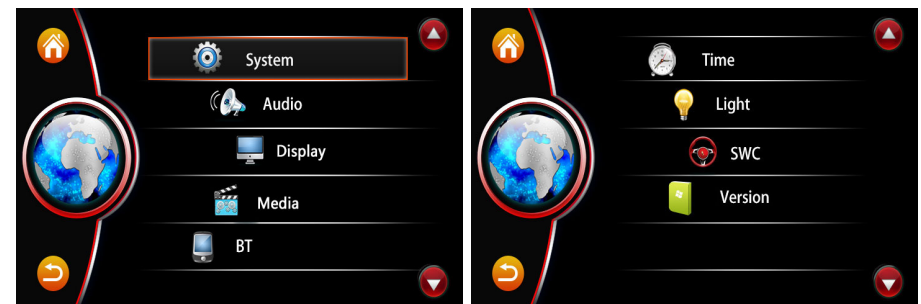

## **SYSTEM**

### • Area

Changes the AM/FM radio frequency spacing/steps based on area set. Select the area on to the right to make a change.

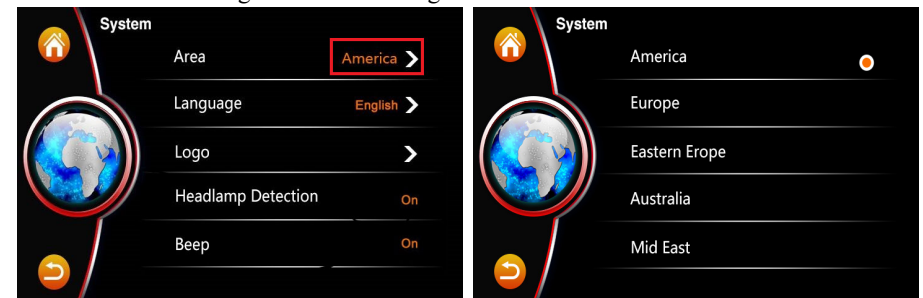

- **Language**

Changes the SYSTEM MENU language. Select the area to the right to make a change.

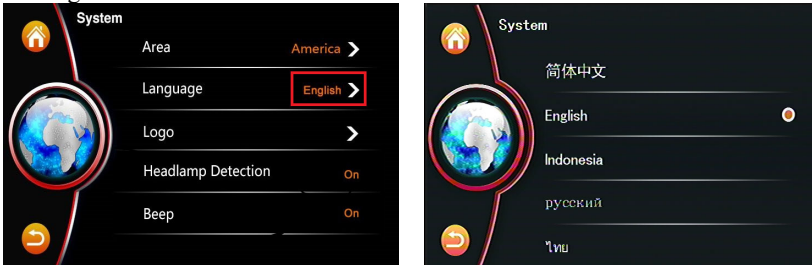

- **Logo**

The user can change the initial Boot-up logo screen. First enter “3368” in the screen below:

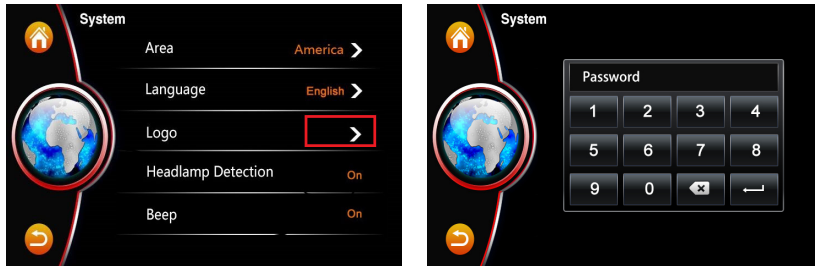

Next, select from a list of factory options.

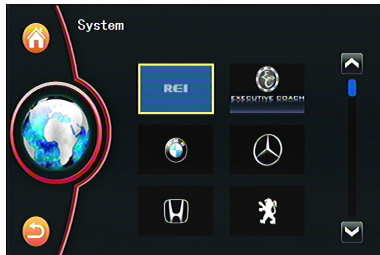

- **Rear Camera**

Select either ON/OFF to enable Rear Camera trigger with the Pink +12V wire.

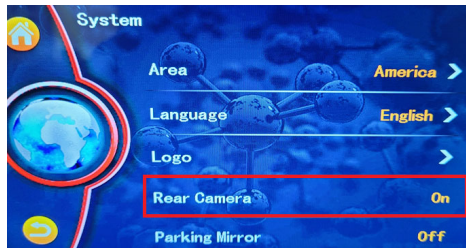

**SPECIFICATIONS:**

**General Specifications**

Dimensions	178(W) x 157(D) x 100(H)
Operating Voltage	(10.0 –18V allowable)
Maximum Current Consumption	10A (7mA Standby)
Handbrake Trigger	Ground
Backup Camera trigger input	+12V DC
Camera 2 trigger output	+12V DC (500mA)
Amp trigger output	+12V DC (500mA)
Antenna trigger output	+12V DC (500mA)

**POWER OUTPUT**

Continuous Output (4Ω, 1kHz at 10% THD)	4 x 22 Watts
Maximum Power Output	4 x 50 Watts
Speaker Impedance	4-8 Ohms

**FM STEREO RADIO**

Frequency range	AMERICA 87.5MHZ – 107.9MHZ (0.2 MHz step) EUROPE 87.50MHZ –108.00MHZ (0.05 MHz step)
Usable Sensitivity	10.2 dBf. (0.9 uV, 75Ω)
50db Quieting Sensitivity	15.2 dBf. (1.6 uV, 75Ω)
Frequency Response	30Hz – 15kHz (+/- 3dB)
Alternate Channel Selectivity	75dB
Stereo Separation	40dB (1kHz)
Image Rejection Ration	75dB
IF rejection ratio	100dB
Signal to Noise ratio	70dB (@60dBuV, stereo)

**AM RADIO**

Frequency range	AMERICA 530kHz – 1710kHz (10 kHz step) EUROPE 522kHz – 1620kHz (9 kHz step)
Usable Sensitivity	28 dB/uV (25uV, S/N 20dB)

**CD/DVD PLAYER**

Signal/Noise Ratio (1kHz)	≥ 85dB
Frequency Response (+/- 1dB)	10 – 20,000Hz (+/-1dB)
Total Harmonic Distortion (1kHz)	≤ 0.20% (1Khz)
Number of Channels	2 (stereo)
Playable disc media:	DVD-VIDEO, VIDEO-CD, CD, CD-R,CDRW,DVD-R,DVD-RW, DVD-R DL
Playable CD disc file format:	ISO 9660 Level 1/2, Romeo, Joliet

## ELECTRICAL CONNECTIONS

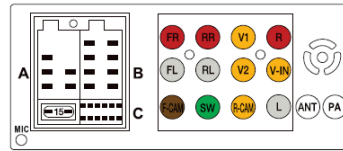
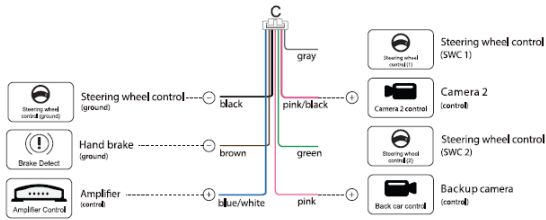
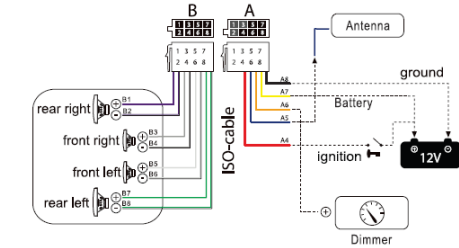

<b>FR:</b> (Red)	Front right Audio output
<b>RR:</b> (Red)	Rear right Audio output
<b>V1:</b> (Yellow)	Video output
<b>R:</b> (Red)	Auxiliary right Audio input
<b>FL:</b> (White)	Front left Audio output
<b>RL:</b> (White)	Rear left Audio output
<b>V2:</b> (Yellow)	Video output
<b>V-IN:</b> (Yellow)	Auxiliary Video input
<b>F-CAM:</b> (Brown)	Camera 2 input
<b>SW:</b> (Green)	Sub-woofer Audio output
<b>R-CAM:</b> (Yellow)	Backup camera input
<b>L:</b> (White)	Auxiliary left Audio input
<b>ANT:</b> (ANT)	Antenna
<b>PA:</b> (PA)	Public Address Input
<b>MIC:</b> (MIC)	External BT Microphone Input

### Warning:

For safety reasons, you cannot continuously view a video source on the built-in monitor when the vehicle is in motion. This is a violation of federal law. To display video, the Brown handbrake wire of the included harness must be hardwired into the parking brake ground circuit, and the parking brake must be engaged.

### • Parking Mirror

Select either ON/OFF to Mirror or Reverse the back-up Camera image.



### • Headlamp Detection

Select either ON/OFF to enable LCD dimming with the Orange +12V Dimmer wire.

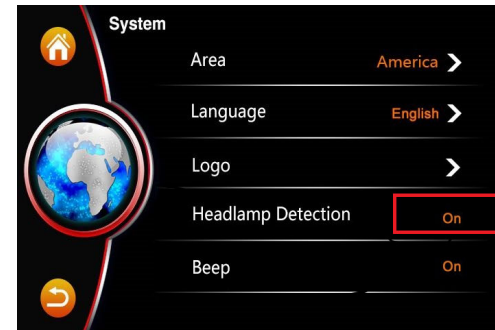

### • Beep

Select either Beep ON/OFF to enable beep sounds with key presses.

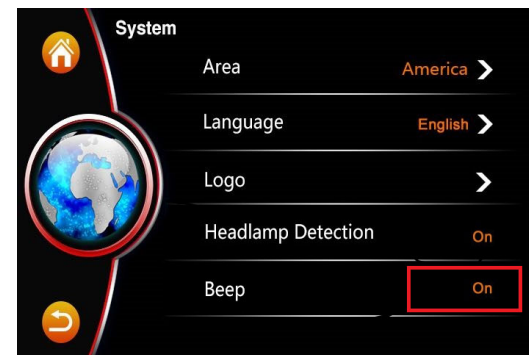

## AUDIO

- **EQ**

The Equalizer Custom adjustment screen allows the user to easily adjust frequencies to meet their acoustical preferences. Select the arrows to make a change from preset curves Standard, Classic, Rock, Pop, Jazz, Electric, or back to Custom. When the user changes any setting, the EQ defaults to CUSTOM.

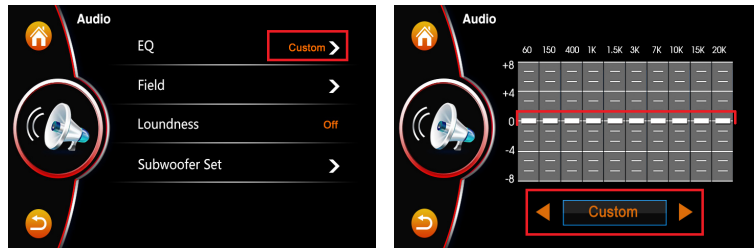

- **Field**

Allows the user to personalize the Balance/Fader levels.

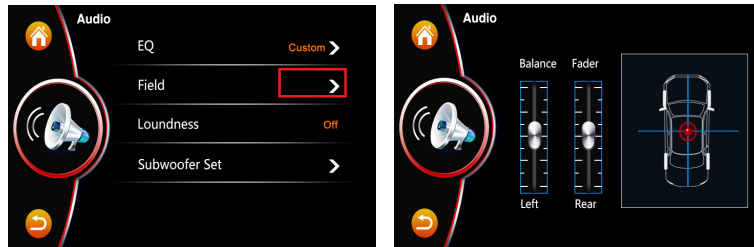

- **Loudness**

Select to either turn the LOUDNESS feature ON/OFF.

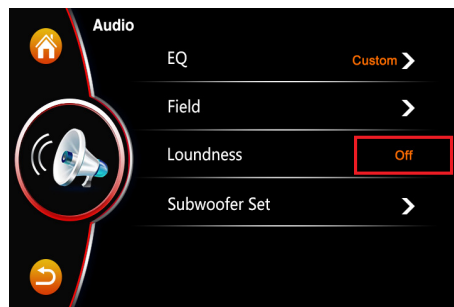

## RADIO REMOVAL

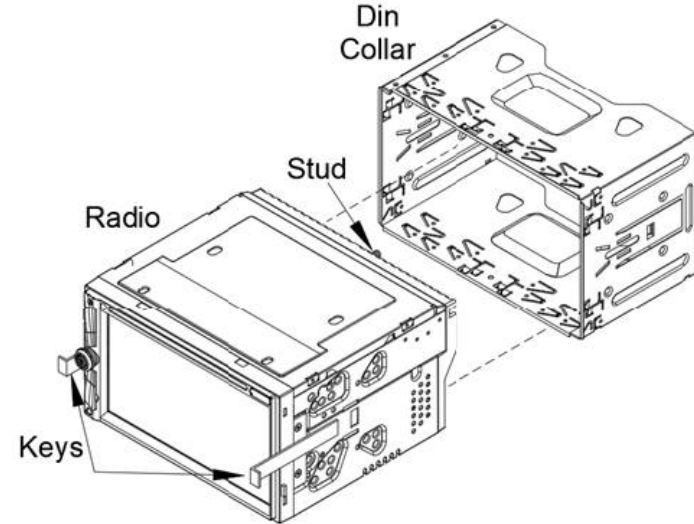

To remove the radio when installed using the DIN collar, remove the Trim Ring if installed. Then insert the removal keys in both sides to release the lock clips and gently pull the radio free from the dash.

## PA OPERATION (microphone sold separately)

Connect a Dynamic PA microphone into the 4-pin connector pig tail on the rear. Microphone has priority over all other audio modes and mute's the source audio being played when keyed. The PA mic volume level will be remembered and will be separate from the master volume

The PA operates regardless of radio status just as long as both ACC and Battery power is applied to the radio.

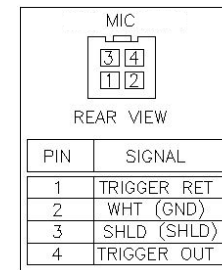



### DIN COLLAR INSTALLATION:

Place the DIN collar into the dash opening. Bend the tabs outward as shown on the drawing below to lock into place.

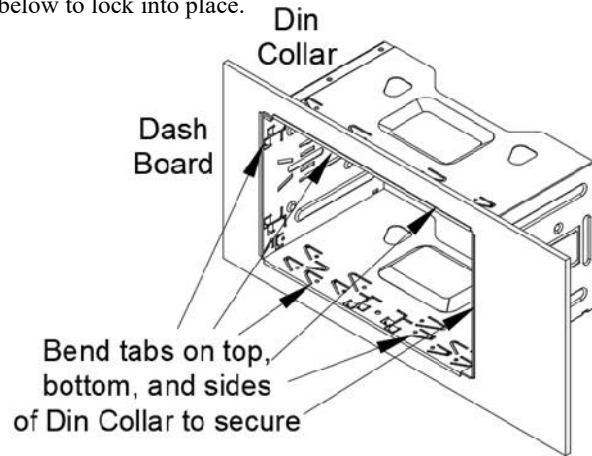

Pass the harnesses and antenna cable through the DIN collar and connect to the back of the radio. Verify clearance; then gently insert the radio into the DIN Collar until both spring clips are locked into place. A Trim Ring is provided to improve the appearance if necessary.

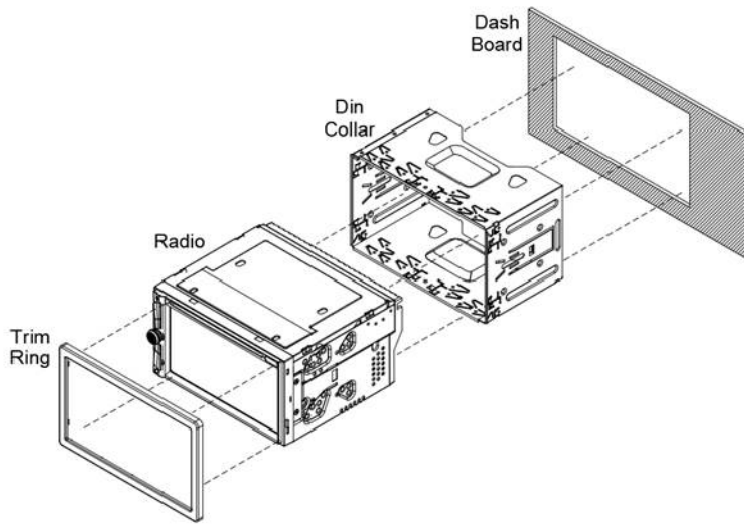

- **Subwoofer Set**

Select to change the Low Pass Filter Setting and gain level of the Subwoofer Line output.

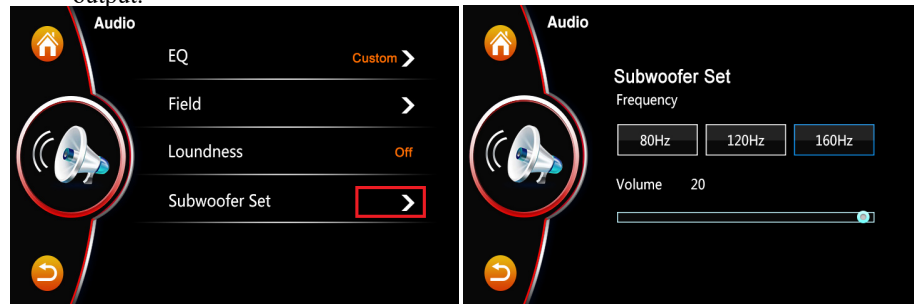

### DISPLAY

- **Type**

Select from Standard, Light, Soft, Bright, or Custom to make changes to the LCD display.

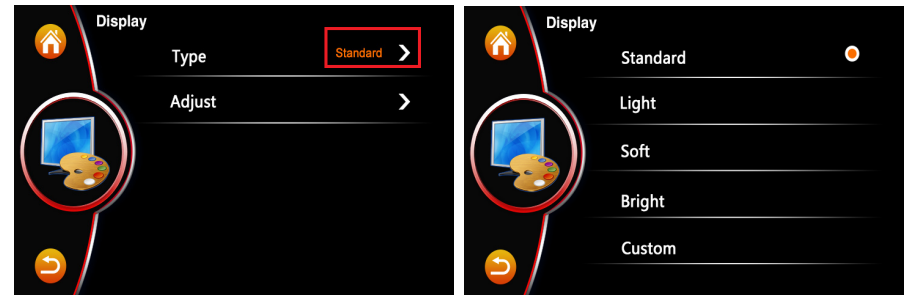

- **Adjust**

Changing the type to Custom, allows the user to modify the backlight settings of the LCD screen.

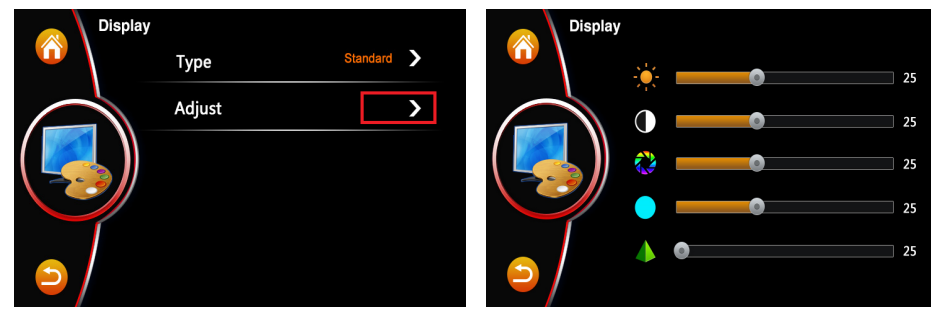

## MEDIA

- **Menu Language**

Select the DVD default menu language. Swipe up/down to for choices. Select the area on the right to make a change.



- **Rating**

After entering the devices password, the user can limit DVD playback based on the formatted rating of the DVD. Swipe up/down to for selections. Select the area on the right to make a change.

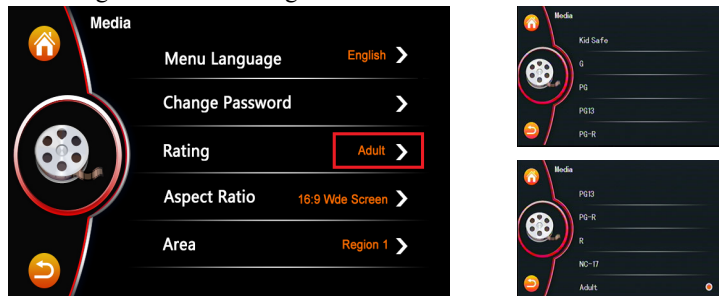

## RADIO DIMENSIONS

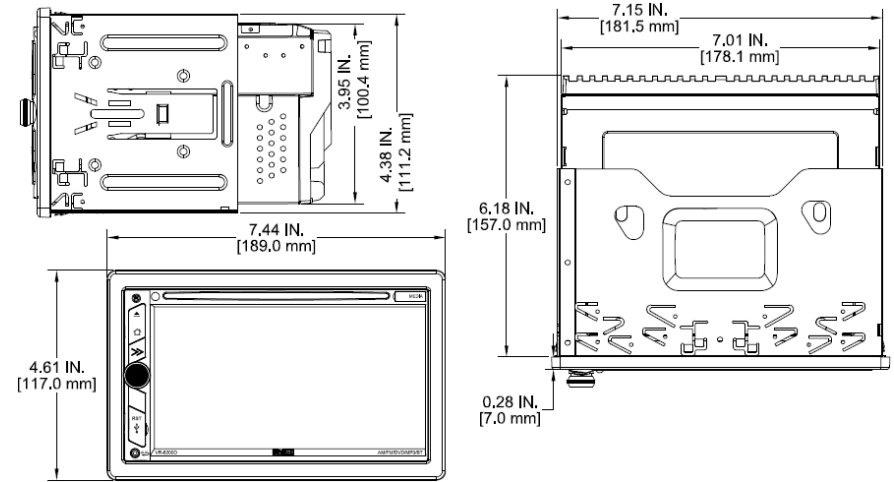

## RADIO INSTALLATION

### ISO INSTALLATION:

This is for installations that do NOT require the use of the DIN collar. The radio has threaded holes in the chassis side panels for ISO mount applications. If necessary, qty 8 M5x8mm screws are included with the hardware pack to assist you.

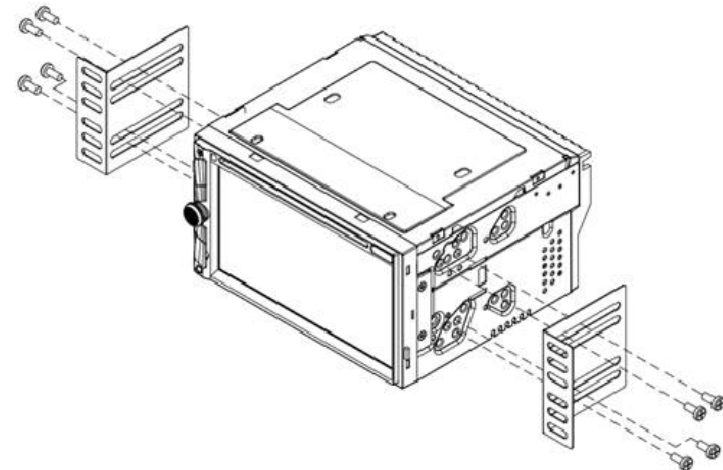

## TROUBLE SHOOTING

Problem	Cause	Solution
Unit will not power on.	No power to BATTERY wire or ACC wire. Blown 15A main fuse.	Check for both ACC & BATTERY voltage with Multi-meter. Check all fuses.
Cannot tune radio stations.	The antenna cable is not connected. The signal is too weak. The radio is in the wrong frequency AREA.	Connect the antenna cable. Check that the radio AREA is set to the correct location. Check that powered antenna is supplied +12V DC.
USB media not playing or says Invalid File Type.	Media is the wrong file type.	Convert files to a usable format. See supported file types section of the manual.
Cannot stream Bluetooth® audio.	Bluetooth® device was not successfully paired. Verify Bluetooth® connected icon. Turn the volume up on the device.	Pair the Bluetooth® device following the steps in the manual and retry. Try an alternate audio player APP on your device.
Aux audio is distorted or low.	Source audio level is too weak or overdriven. Bitrate of audio file is too large.	Adjust the volume level of the auxiliary source. Change the sample frequency or Bitrate of the file.
Discs will not play or display loading for an extended period.	DVD/CD discs will not play unless the disc is finalized after authorizing in software.	Finalize the media before playing in the unit. Verify that the files meet the requirements of the supported file types.
Rear view Camera is not displayed.	Camera not working or trigger is not connected properly.	Verify camera has power and that the control wire is connected properly.
PA is not operational.	PA used is not pinned correctly. PA is the wrong type.	The PA used must be a Dynamic vocal microphone.

- Aspect Ratio**

Personalize the aspect ratio of the CVBS output signal between 4:9 and 16:9.

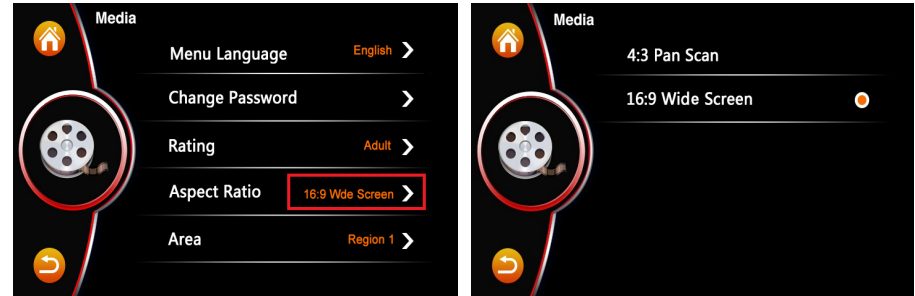

- Area**

Use this to change the DVD region code lock for your area. Swipe up/down to for selections. Select the area on the right to make a change.

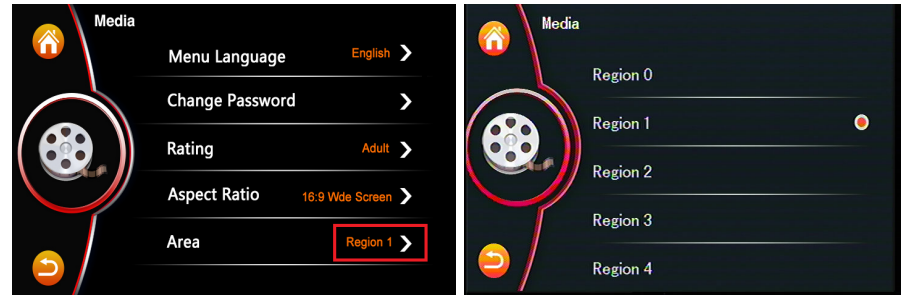

## BT

- Name**

Touch to change the Bluetooth ID of the radio. Use the keyboard to enter the ID, then confirm.

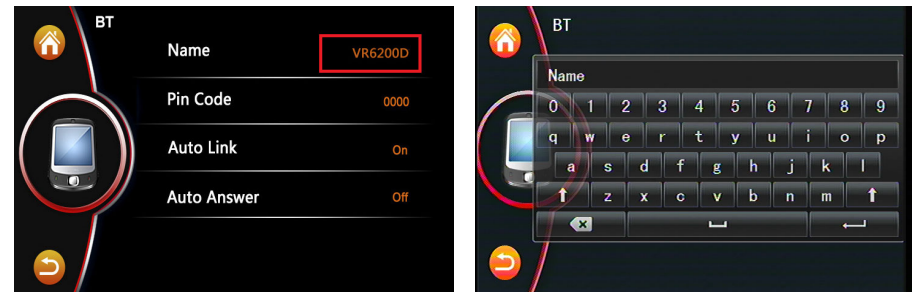

- **Pin Code**

This is the customizable passkey necessary to pair a Bluetooth® device. Default is “0000” or “8888”.

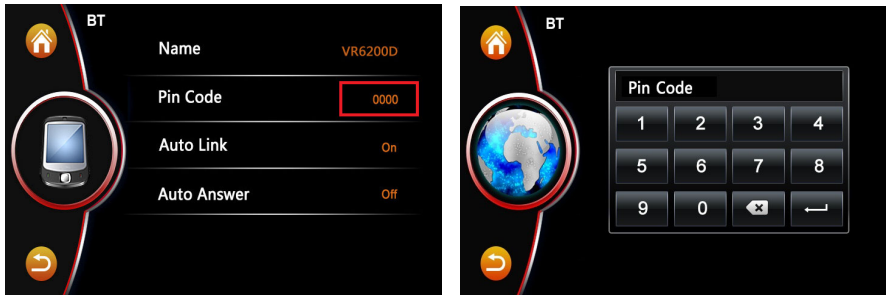

- **Auto Link**

Touch to enable auto connect ON/OFF between your phone and the radio.

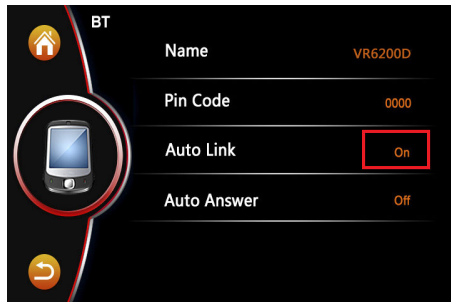

- **Auto Answer**

Touch to turn auto answer of Bluetooth phone calls ON/OFF between your phone and the radio.

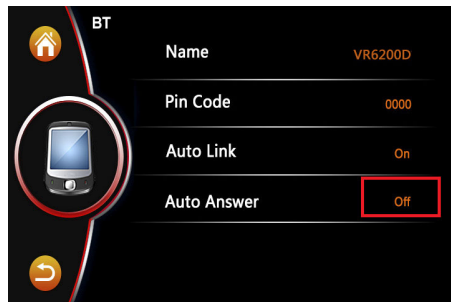

The Bluetooth® word mark and logos are registered trademarks owned by Bluetooth SIG, Inc., and any use of such marks by REI is under license.



DivX®, DivX Certified® and associated logos are trademarks of Rovi Corporation or its subsidiaries and are used under license. DivX Certified® to play DivX® video, including premium content. Covered by one or more of the following U.S. patents: 7,295,673; 7,460,668; 7,515,710; 7,519,274



uSD is a trademark or registered trademark of SD-3C, LLC in the United States, other countries, or both.

### REMOTE CONTROL

1. **POWER/MUTE BUTTON**  
Press to MUTE. Hold to POWER the unit ON or OFF.
2. **SOURCE BUTTON**  
Press to change to the next source on the unit.
3. **PLAY/PAUSE BUTTON**  
Press to PAUSE in playback mode. Press again to PLAY in pause mode.
4. **CURSOR BUTTONS**  
In DISC menu mode, these buttons move the cursor. Press ENT to execute command.
5. **SEEK+/- BUTTONS**  
In radio mode, press and hold to SEEK stations. Press and release to manually tune stations. In DVD/USB/uSD mode, press and hold to advance x2, x4, x8, or x20. Press to skip chapters.
6. **NOT USED**
7. **LOUD/EQ BUTTON**  
Press to change EQ settings. Hold to turn LOUD ON/OFF.
8. **NUMBER (1-10) BUTTONS**  
In radio mode, press number key 1-6 to store up to 6 radio stations. In DVD/USB/uSD mode, press any number 1-9 for the desire track. Press and HOLDE for alternative features.
9. **VOLUME +/- BUTTONS**  
Buttons adjust the source volume up/down.
10. **MENU BUTTON**  
Press to access the HOME screen.
11. **BAND/STOP/CALL END BUTTON**  
Use this button to reject or end a Bluetooth call. In MEDIA playback mode, press to STOP. Change BANDS in AM/FM Mode.
12. **CALL OUT BUTTON**  
Use to place a call with a paired Bluetooth phone, or pick up an incoming call. Hold to transfer conversation between radio and phone.

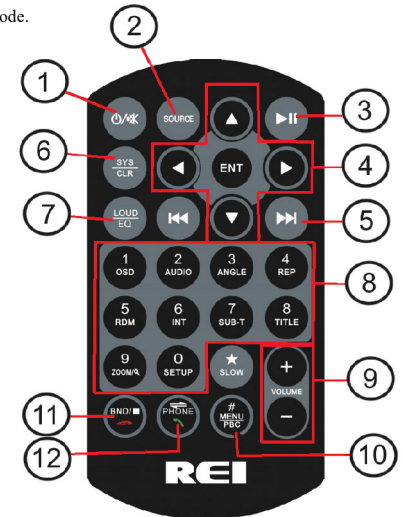

Remote requires a 3V battery CR2025 for operation.

**WALLPAPER**

Touching this ICON changes the desired background image on the screen.



**BACK-UP CAMERA OPERATION**

The Radio has rear Back-up camera input. You must install the Composite video signal for the back-up camera to the R-CAM RCA input of the Radio. The PINK “Back-up” control wire must then be connected to the vehicle’s +12V DC REVERSE trigger. When leaving reverse gear, the unit displays the previous screen.

*Note:*  
When backing up your car, watch the surroundings carefully for safety. Do not depend on the rear-view camera exclusively.

**SUPPORTED AUDIO FILES**

Type	Format	Bit rate	Sampling Frequency	Bit count
AAC-LC (.m4a)	MPEG2/4 AAC LC HE-AAC(V1,V2)	8 – 320kbps, VBR	16 – 48 kHz	16 bit
MP3 (.mp3)	MPEG 1/2 Audio Layer 3	8 – 320kbps, VBR	16 – 48 kHz	16 bit
WMA (.wma)	Windows Media Audio Standard L3 profile (Version 7,8,9)	8 – 320kbps	16 – 48 kHz	16 bit
FLAC (.flac)	flac		16 – 192 kHz	16 bit/24 bit

**SUPPORTED VIDEO FILES**

**MPEG-4**

- Real time HD (up to 1080p) H.264
- Profiles Main & High levels 1~4.2
- Real time HD (up to 1080p) RealVideo 8/9/10 decoding
- Real Time MPEG-4 Simple/Advanced Simple D1 profile decoding

**DivX®**

- Files encoded with Xvid or DivX Profiles, Max frame rate 30 fps (30p/60i)
- Video Codec: MPEG-4 Advanced Simple Profile
- Audio Codec: MP3/AC3/PCM

**MPEG-1/MPEG-2**

- Video Codec: MPEG1/2 MPG1/2
- Audio Codec: MP2/3
- Frame rate: Max. 30 fps (30p/60i)
- Image size: Max. 720x480 pixels

• **Auto Loading Records**

Touch to turn ON/OFF automatic loading of incoming calls/dialed out numbers/ missed calls from the phone to the radio.

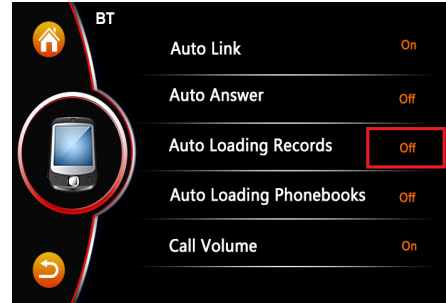

• **Auto Loading Phonebooks**

Touch to turn ON/OFF the automatic loading of your phones contact list to the radio.

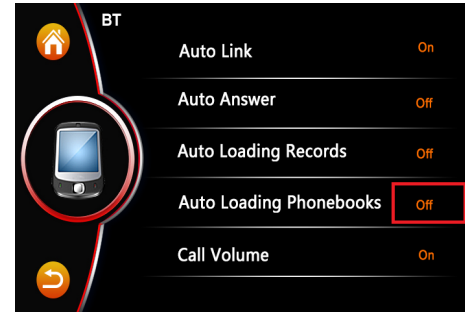

• **Call Volume**

When set to ON, the call volume level is saved independently from the source. When set to OFF, the call volume is the same level as the current source.

Note: Volume level can be adjusted at any time during Bluetooth conversation.



## TIME

- **Display Mode**

Choose the format to display the current date.

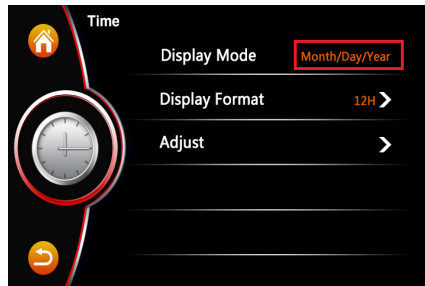

- **Display Format**

Touch the right side to change the time from 12hr/24hr format.

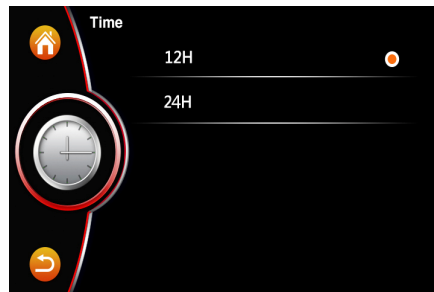

- **Adjust**

Touch the arrows to change the radios Date/Time.

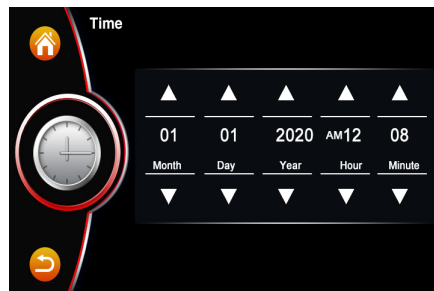

## NOTE:

When there is an incoming call, the song will pause. After the incoming call is finished, the screen will return to the music function screen and playback will continue. Functionality may vary depending on the profile or device used.

## AUX/VIDEO IN OPERATION

Select the AVIN icon to play Analog audio/Video when connected to the rear A/V input RCA's or the front 3.5mm AUX audio input.

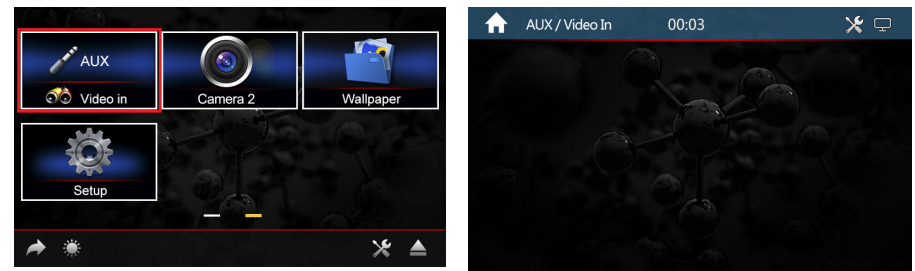

## CAMERA 2 OPERATION

Select the Camera 2 icon to display Video when connected to the rear CVBS F-CAM input RCA. When selected, the Pink/Black Camera 2 control wire for the radio provides +12V DC (500mA) to power an external camera. Press the HOME button or select the Camera 2 text in the upper left hand of the screen to exit.

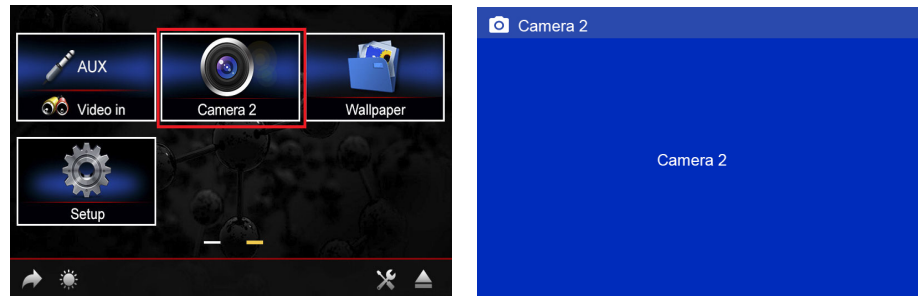

## CONTACTS BUTTON

After accessing the Contacts menu, the user has the following options:

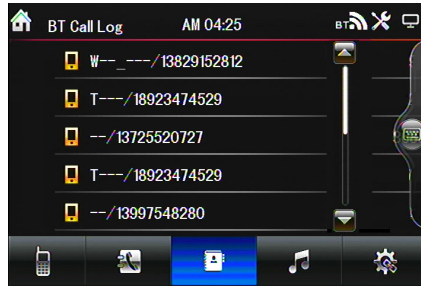

- Scroll up/down and press to select the desired contact.
- Press the Keyboard icon on the right to search contacts by name. The number will display in the Status window, but the number will not be dialed until the Place Call Button is pressed.

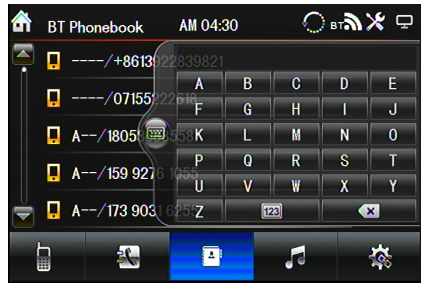

## BLUETOOTH® STREAMING AUDIO BUTTON

The radio allows you to play back audio files from your mobile device using a Bluetooth® connection. The Radio can control the player on your phone via Advanced Audio Distribution Profile (A2DP).

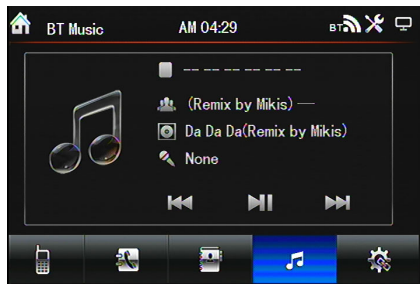

While listening to audio the following radio functions are available:

- PREVIOUS** button: Touch to play the previous track.
- PLAY/PAUSE** button: Touch to pause playback. Touch again to resume playback.
- NEXT** button: Touch to play the next track.

## LIGHT

### • Backlight Adjustment

Slide the top setting to set brightness of screen when set at USER MODE.

Slide to bottom setting to set brightness of screen when the DIMMER is active.

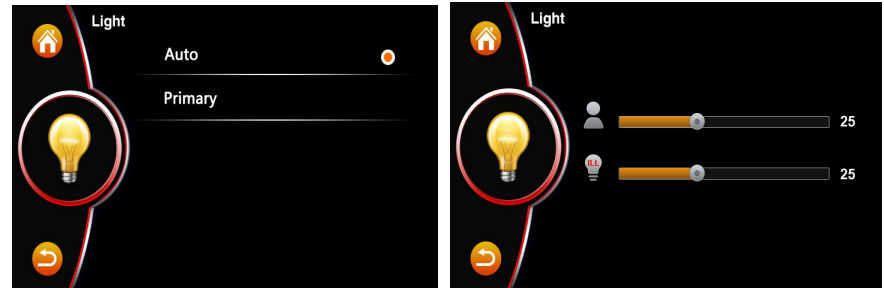

### • Color Light

Touch to select either Auto or Primary. When set to Auto the button backlight changes according to the time chosen. When set to Primary, the button backlighting remains on what color is selected.

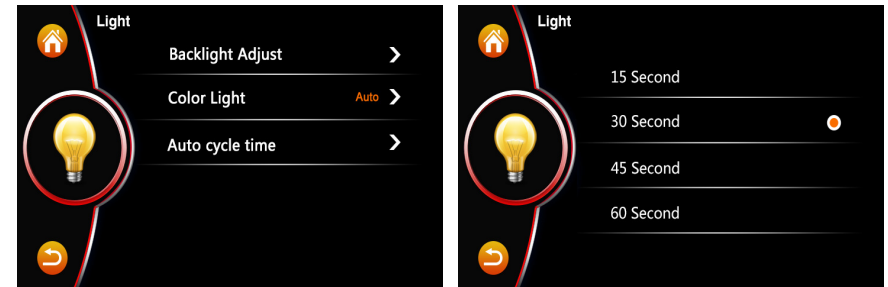

### • Color Selection

Touch to select the Primary button backlighting color. Swipe up/down to select the setting. Select the area on the right to make a change.

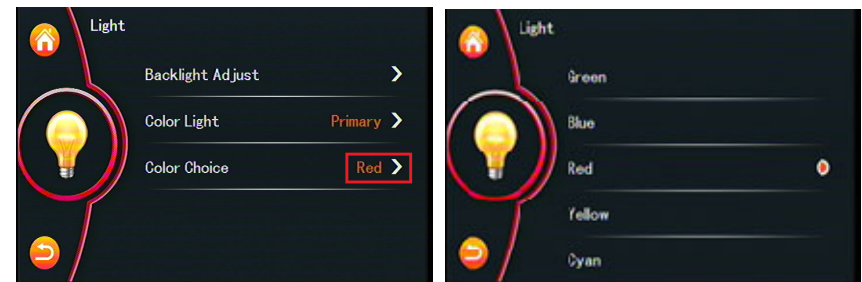

## SWC

- **Steering Wheel**  
Touch to turn the Steering Wheel Control ON/OFF.
- **Study**  
When set to on, use the Study option to adjust settings. Features may not be compatible with all vehicles.

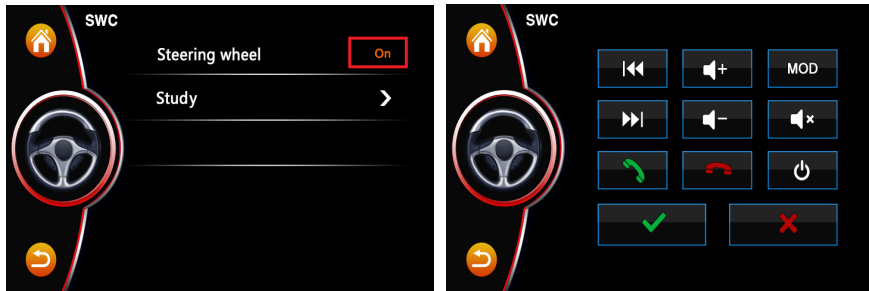

## Version

- Touch to verify the firmware version on the radio.

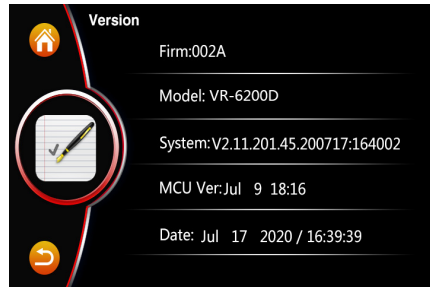

## RADIO

Select the RADIO icon to listen to the radio.

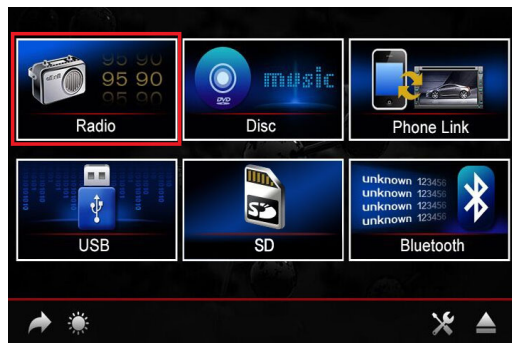

1. **Phone number:** Displays the incoming or outgoing phone number. The connected Phone ID is also displayed.
2. **Number keys:** Touch 0-9, \*, # to enter the phone number you wish to dial.
3. **Keypad button:** Touch to return to the Phone keypad screen.
4. **Recent calls:** Press to access the call history page.
5. **Contacts button:** Press to access contacts of the paired phone.
6. **Bluetooth® Music shortcut button:** Press to change the mode to A2DP Bluetooth® steaming music.
7. **Connection button:** Press to access the Connection screen.
8. **Answer/Place Call button:** Press to place or answer an incoming call.
9. **Delete button:** Press to delete the last digits entered in the display.
10. **Call End:** Press to end a call.
11. **Call Mute:** Press to mute a call.
12. **Call Transfer:** Press to transfer the call between the phone and the radio.

## RECENT CALLS

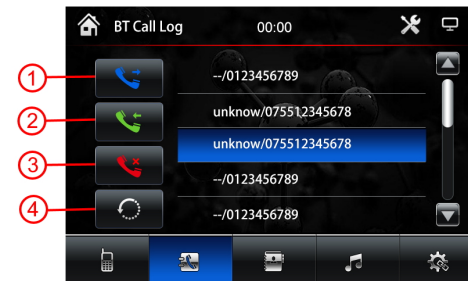

1. Display a list of all **RECEIVED** calls.
2. Displays a list of all **DIALED** calls.
3. Displays a list of all **MISSED** calls.
4. Press to **LOAD** calls in the phones logged calls list.



## CONNECTING A BLUETOOTH® DEVICE:

To connect your Bluetooth® device to the radio, the device must first be paired. A paired device can be removed by selecting the device, then selecting the “X” at the far right of the device name.

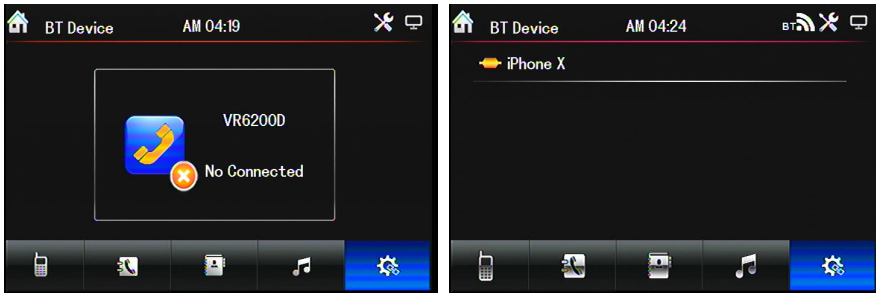

### Pairing the Your mobile device with the Head Unit

Your mobile phone can initiate a search for new devices and pair to the unit. The following paragraph describes the pairing process:

*NOTE: Procedures for pairing mobile phones may vary slightly from manufacturer to manufacturer.*

1. Verify that the Radio is powered up and ON.
2. Set the Bluetooth® function of the Mobile Device to ON.
3. Access the “Look for devices” feature of the Mobile device and begin searching. After searching, the Radio should appear in the list of devices as VR6200D. Press to accept.
4. A prompt to pair should appear on your Mobile device. Press to accept and continue the process. The device will then ask for the passkey, enter it on the mobile device.

*NOTE: Some mobile devices require the passkey to connect. If your mobile device requires the passkey, you will need to enter it now. The default code for the Radio unit is “0000”.*

5. After entering the passkey, press OK. The Mobile device should display connected. The Bluetooth® icon should appear in the upper right-hand corner of the HOME page.



### NOTES:

- Only ONE mobile device can be paired with the Radio at a time.
- The Radio is always in discovery mode.
- This Radio does NOT support HSP (Headset Profile)
- An optional external remote Bluetooth Microphone is available (P/N 480335). Contact an REI sales for information.

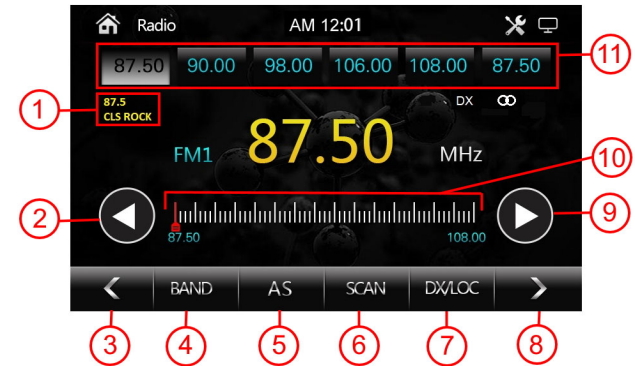

1. **RDS information:** Scrolls station PS/RT info
2. **SEEK BACK button:** Press to SEEK back to previous stations.
3. **Tune BACK button:** Press to manually tune to lower frequencies.
4. **BAND button:** Press this button to change to FM1/FM2/FM3 or AM1/AM2 frequency bands.
5. **AS Auto Store:** Press to set all the presets in that BAND to the strongest stations.
6. **SCAN button:** Press this button to automatically preview all radio stations for 5 seconds beginning at the lowest frequencies.
7. **LOC/DISTANCE button:** Press to adjust the tuner SEEK sensitivity to select only weaker (DX) or stronger (LX) stations only.
8. **Tune UP button:** Press to manually tune to higher frequencies.
9. **SEEK Up button:** Press to SEEK forward to the next station.
10. **Quick access bar:** Press within this area to quickly access frequencies.
11. **Preset Memory/Recall buttons:** Press momentarily to select the displayed preset station. Press and hold any button to preset the current station.

### DISC

Select the DISC icon to change the mode to CD/DVD playback. For playback of a DVD:

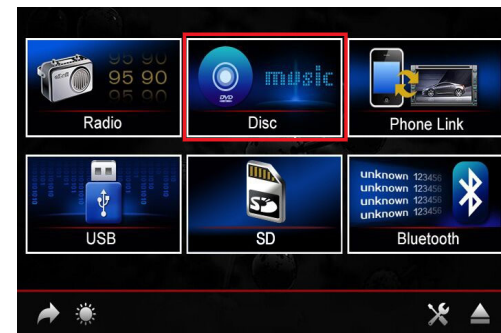

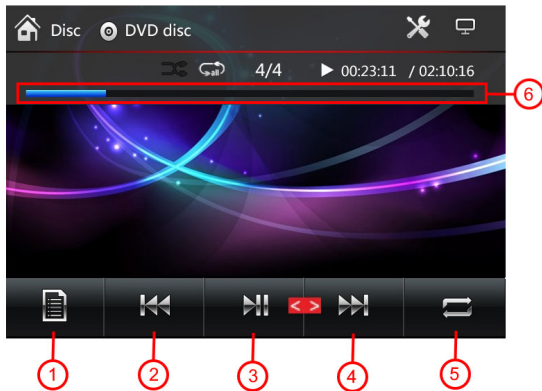

**PAGE 1 of 3**

1. **TITLE button:** Touch to access the DISC TITLE when available.
2. **PREVIOUS CHAPTER:** Press to skip to the PREVIOUS chapter. Hold to REW x2, x4, x8, or x20 on DVD only.
3. **PLAY/PAUSE button:** Touch to pause playback. Touch again resume playback.
4. **NEXT CHAPTER:** Touch to skip to the NEXT chapter. Hold to FF x2, x4, x8, or x20 on DVD only.
5. **REPEAT button:** Touch to change the repeat option from Chapter, TITLE, & OFF.
6. **PROGRESS BAR:** Press within to access any point in the disc. Use the bar to advance withing the track.

The **FILE ACCESS** button allows access to different file types:

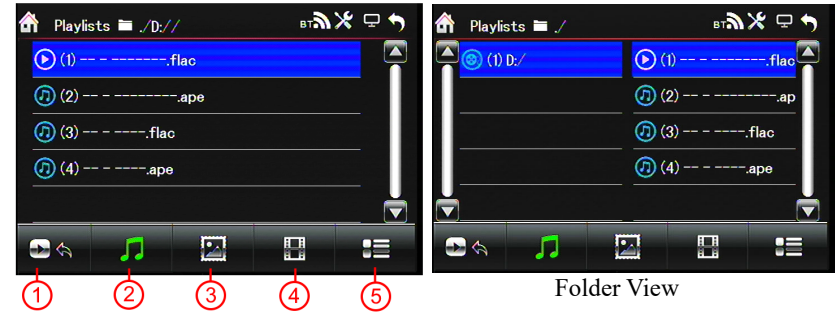

1. **Return:** Touch to return to the previous view.
2. **AUDIO Files:** Touch to display the available audio files. Touch the file name to select a specific file. Touch again to begin playback.
3. **IMAGE Files:** Touch to display available image files. Touch the file name to select a specific file. Touch again to begin filmstrip playback.
4. **VIDEO Files:** Touch to display the available video files. Touch the file name to select a file. Touch again to begin playback.
5. **Selects Folder View:** Touch the icon to display the folder/file hierarchy. Touch the folder icon twice and the contents of the folder will be displayed.

**BLUETOOTH® OPERATION**

Use this ICON to access the built in Bluetooth modes.

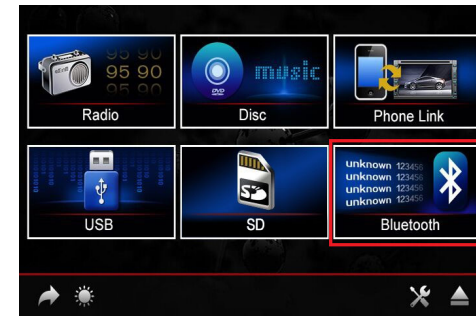

## USB/SD

Insert a USB/uSD into the radio and it will automatically switch to this input. If using any other source, press the HOME button and select USB/SD to begin playback.

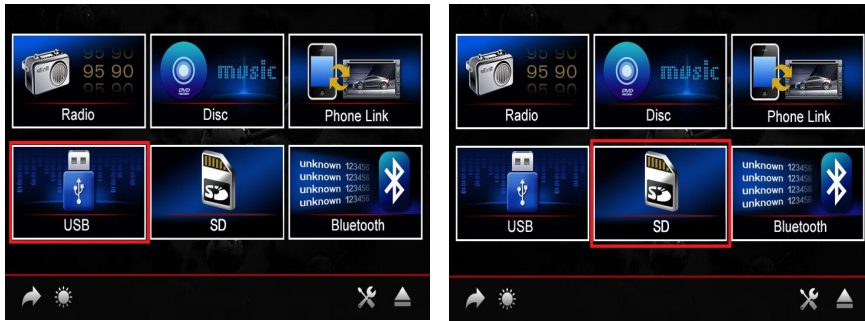

## File playback

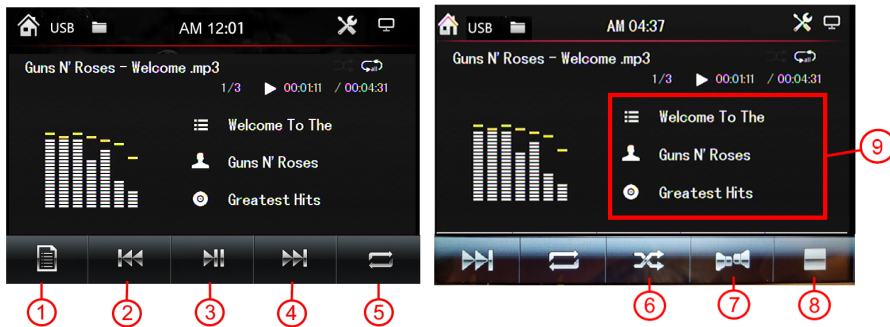

1. **File Access** button: Touch to select a specific file for playback
2. **PREVIOUS** button: Touch to skip to the previous track or chapter.
3. **PLAY/PAUSE** button: Touch to pause playback. Touch again to resume playback.
4. **NEXT** button: Touch to skip to the next track or chapter.
5. **REPEAT** button: Touch to change the repeat option from DIR, ALL, or ONE.
6. **RANDOM** button: Touch to turn random playback ON/OFF.
7. **AUDIO** button: Touch to select either (mono)left, right, or Stereo playback.
8. **STOP** button: Touch to STOP the media.
9. **Track info**: ID3 tag information (Album/Artist/Title).

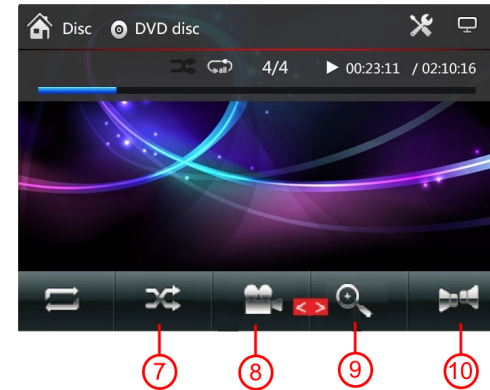

## PAGE 2 of 3

7. **RANDOM** button: Touch to turn random playback ON/OFF.
8. **CAMERA ANGLE**: Press to select from different camera angle available on the disc.
9. **ZOOM IN/OUT** button: Press to Zoom in by x2, x3, x4, x5, 1/2, 1/3 or 1/4
10. **AUDIO** button: Touch to select available audio playback tracks on the disc.

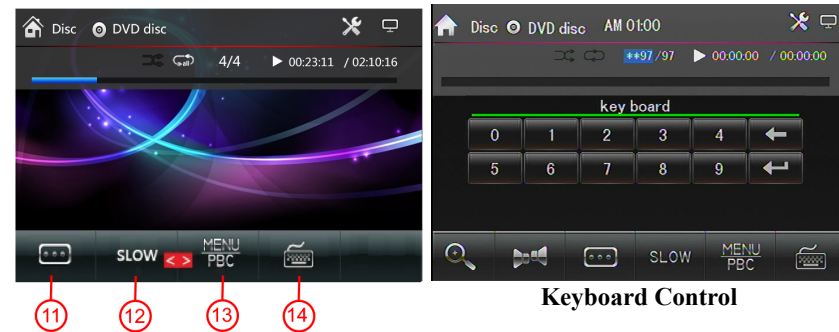

## Keyboard Control

## PAGE 3 of 3

11. **SUBTITLE**: Changes the subtitle language on multi-subtitle discs.
12. **SLOW**: Change to playback in slow motion x2, x3, x4, x5.
13. **MENU/PBC**: Displays the root menu that is stored on the DVD disc.
14. **KEYBOARD**: Press to directly access chapters using the numeric keyboard.

The screen will not continuously display video unless the **BROWN HANDBRAKE** wire is correctly installed, and the vehicle has the parking brake enabled.

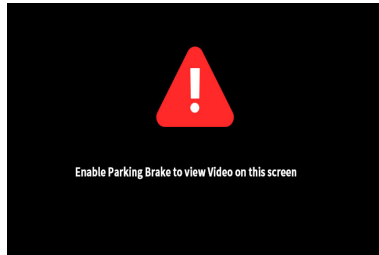

For playback of a CD:  
Press anywhere in the empty portion of the screen to access any of the 3 CD audio playback options.

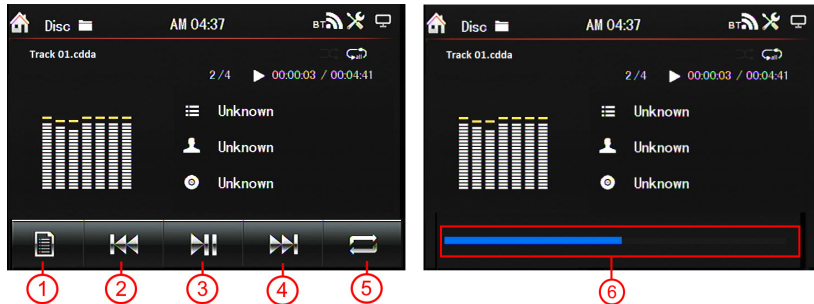
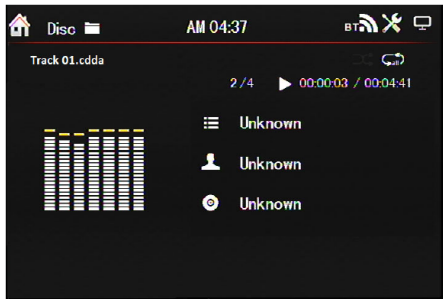

1. **TITLE button:** Touch to access the TRACK MENU for the disc.
2. **PREVIOUS TRACK:** Press to skip to the PREVIOUS track.
3. **PLAY/PAUSE button:** Touch to pause playback. Touch again resume playback.
4. **NEXT CHAPTER:** Touch to skip to the NEXT track.
5. **REPEAT button:** Touch to change the repeat option from Track, All, OFF.
6. **PROGRESS BAR:** Press within to quickly access any point in the track.

## PHONE LINK

Select the Phone Link to start mobile phone linking of the connected mobile phone.

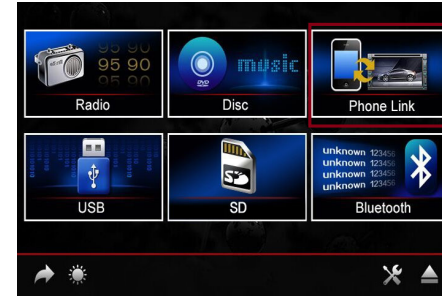

The mobile phone connects the radio through the USB. Using the mirror method, the mobile phone screen will be displayed on the radio and can be operated through the touch screen.

For supported Apple iOS5 and above, mobile phone linking operation will start automatically without any setting. Mirror linking will appear on screen and mobile phone operation can be controlled by touching the screen. The APP is required to allow USB charging of supported Apple devices.

For Android devices, the Autolink Vehicle multimedia entertainment APP is also available from the Google Play Store. When the phone is connected the first time, the following SETUP MENU appears on the screen.

